



WORKS NOTIFICATION

SERVICE RELOCATION, ARDEN 14 AUGUST – MID-SEPTEMBER 2017

Works for the Metro Tunnel Project are now underway with activities taking place ahead of the start of major construction.

John Holland is the Managing Contractor for this package of works, which includes service relocation and demolition of existing buildings within the Arden Station construction site. This area is bounded by Laurens Street, Barwise Street, Moonee Ponds Creek and the Upfield rail lines.

What we are doing

- Installing power cables in the bicycle lane along the western side of Laurens Street; across Laurens Street between Queensberry Street and Barwise Street; and within the Arden Station construction site
- These works will be carried out by open cut trenching which involves excavating a trench and manually installing each piece of conduit then backfilling and reinstating the area.

What to be aware of

- To minimise disruption to traffic and pedestrians, these works will be undertaken in two stages (see map overleaf)

Stage 1 and 2

- We will need to temporarily occupy a limited number of parking spaces on Laurens Street near the work site

- A perimeter will be established around the work site to ensure the safety of the community and work crews
- There will be some temporary cycling and pedestrian diversions
- There will be medium to high level noise associated with saw-cutting activities
- Access to private properties and businesses will be maintained at all times
- There are no planned disruptions to essential services.

Stage 2

- To install the power cables across Laurens Street, the road will be closed at the works location from Tuesday 22 August, for approximately one week. Detours will be in place, please refer to signage.

When

- 14 August to mid-September 2017
- 7am – 6pm, Monday to Friday
- 7am – 1pm, Saturdays

All reasonable efforts will be made to complete works ahead of schedule, subject to weather and ground conditions

We will notify residents and businesses if there are any significant changes to the program.



Construction partners:



Stage 1



Indicative only

Stage 2

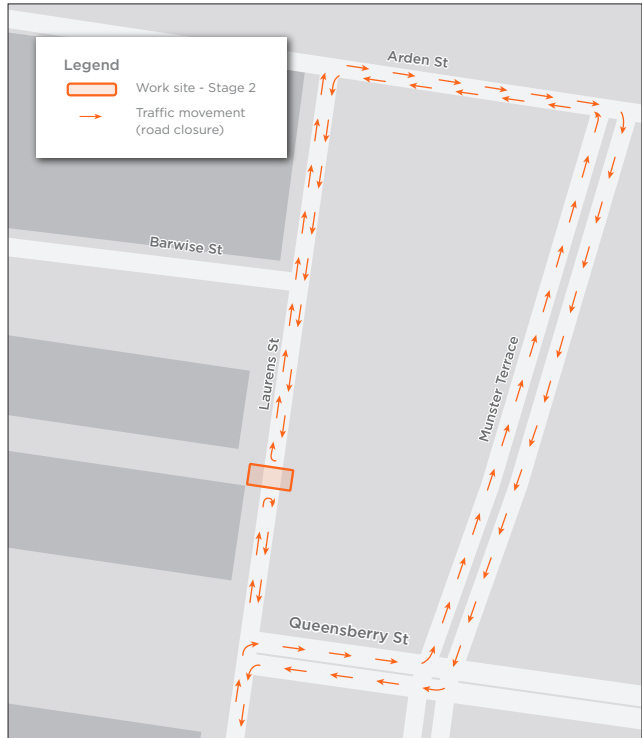

More information

To find out more about the Metro Tunnel Project and register for future email updates:

- metrotunnel.vic.gov.au
- 1800 551 927 (24 hours a day, 7 days a week)
- @metrotunnelvic
- Melbourne Metro Rail Authority
- facebook.com/metrotunnel
- metrotunnelvic
- Melbourne Metro Rail Authority, PO Box 4509, Melbourne, VIC 3001
- Subscribe to eNews: metrotunnel.vic.gov.au/contact-us

Arabic	العربية	Russian	Русский
Cantonese	廣東話	Serbian	Српски
Greek	Ελληνικά	Sinhalese	සිංහල
Italian	Italiano	Spanish	Español
Korean	한국어	Turkish	Türkçe
Macedonian	Македонски	Vietnamese	Tiếng Việt
Mandarin	普通话		

Interpreter Service
(03) 9280 0700



Construction partners:



Authorised and published by the Victorian Government, 1 Treasury Place, Melbourne.