



WORKS NOTIFICATION

GAS COMMISSIONING ACTIVITIES DOMAIN PRECINCT 28 AUGUST UNTIL END OCTOBER 2017

Major works on the Metro Tunnel are now underway to support construction of a new underground station in Domain.

John Holland has been appointed as the Managing Contractor for this package of works.

Testing and commissioning of the gas main

With high pressure gas main installation works now complete across the Domain Precinct, we wish to advise you of the final activities required before switching over to the new gas main. These works will be undertaken in a number of stages and will occur concurrently.

What we are doing

Stage 1

- Tie-in works to connect the new and existing gas mains at both ends of Domain Street and on St Kilda Road, adjacent to the Melbourne Grammar School driveway
- Purging the new gas main in Bowen Crescent, at both ends of Domain Street and on St Kilda Road adjacent to the Melbourne Grammar School driveway. Purging is carried out to clear the pipes of air and involves releasing gas through the main and using a controlled visible flame through a vent connected to the main to remove any air.

Traffic impacts:

- Traffic will be maintained in Domain Street around the works at each end of the street

- Southbound lane closure on St Kilda Road, with no access to Melbourne Grammar's St Kilda Road driveway
- Bowen Crescent will be closed to westbound traffic entering from St Kilda Road during set-up works and closed for **one day** at the intersection of St Kilda Road during purging works.

Stage 2

- Reinstatement works at each location.

Traffic impacts:

- Traffic will be maintained in Domain Street around the works at each end of the street
- Southbound lane closure on St Kilda Road, with no access to Melbourne Grammar's St Kilda Road driveway
- Bowen Crescent will be closed at St Kilda Road in both directions for the duration of the works.

Stage 3

- Installing a new gas regulator in Park Street, South Melbourne which will occur at night to minimise disruption to the tram network
- Connecting the new and existing gas mains at the corner of Park Street and Wells Street, South Melbourne.

Traffic impacts:

- Park Street will be closed to eastbound traffic from Wells Street to St Kilda Road with a detour in place via Wells Street and Dorcas Street.



Construction partners:



Authorised and published by the Victorian Government, 1 Treasury Place, Melbourne.

MMEW-JHG-DM-NTF-STK-0072

Stage 1

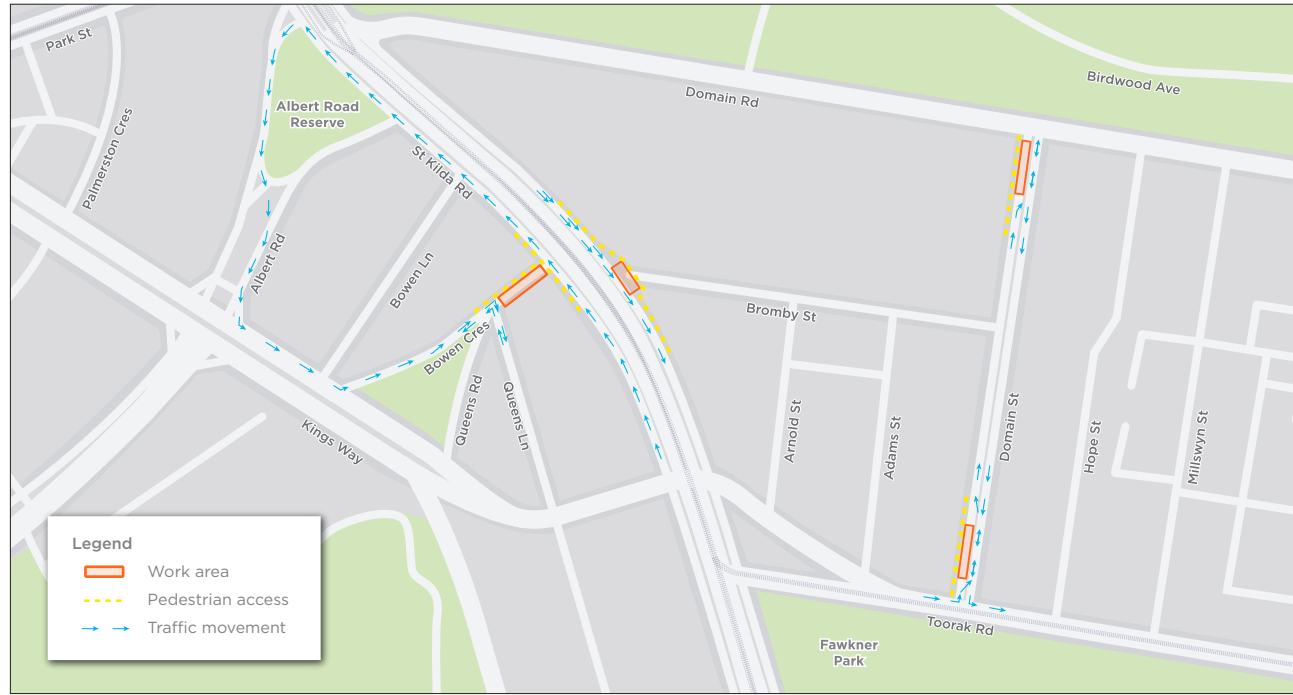

Stage 3

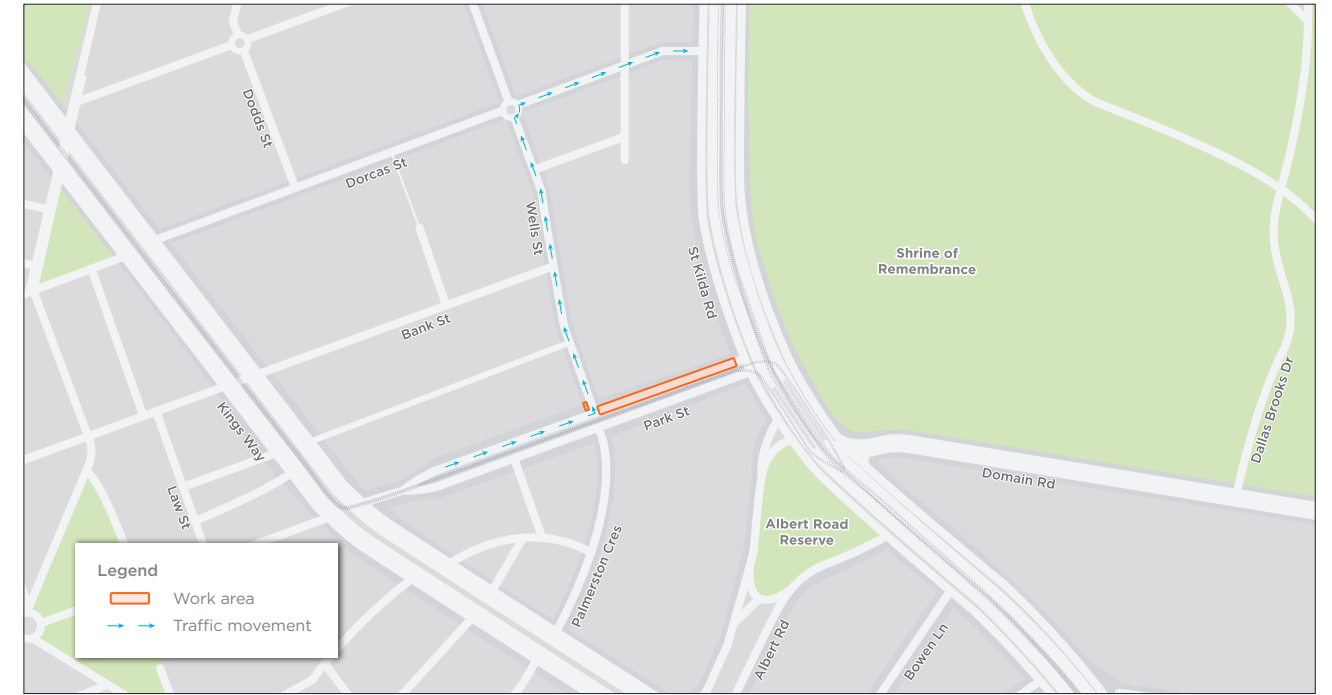

Stage 2

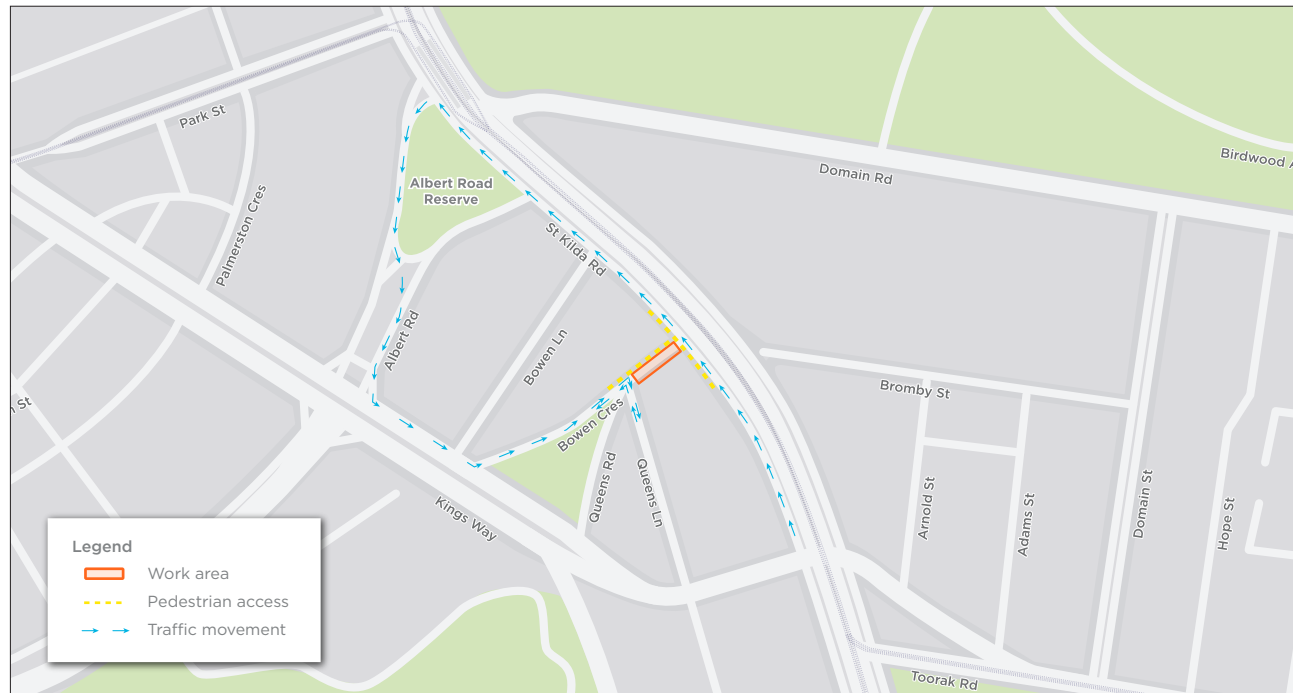

Stage 4

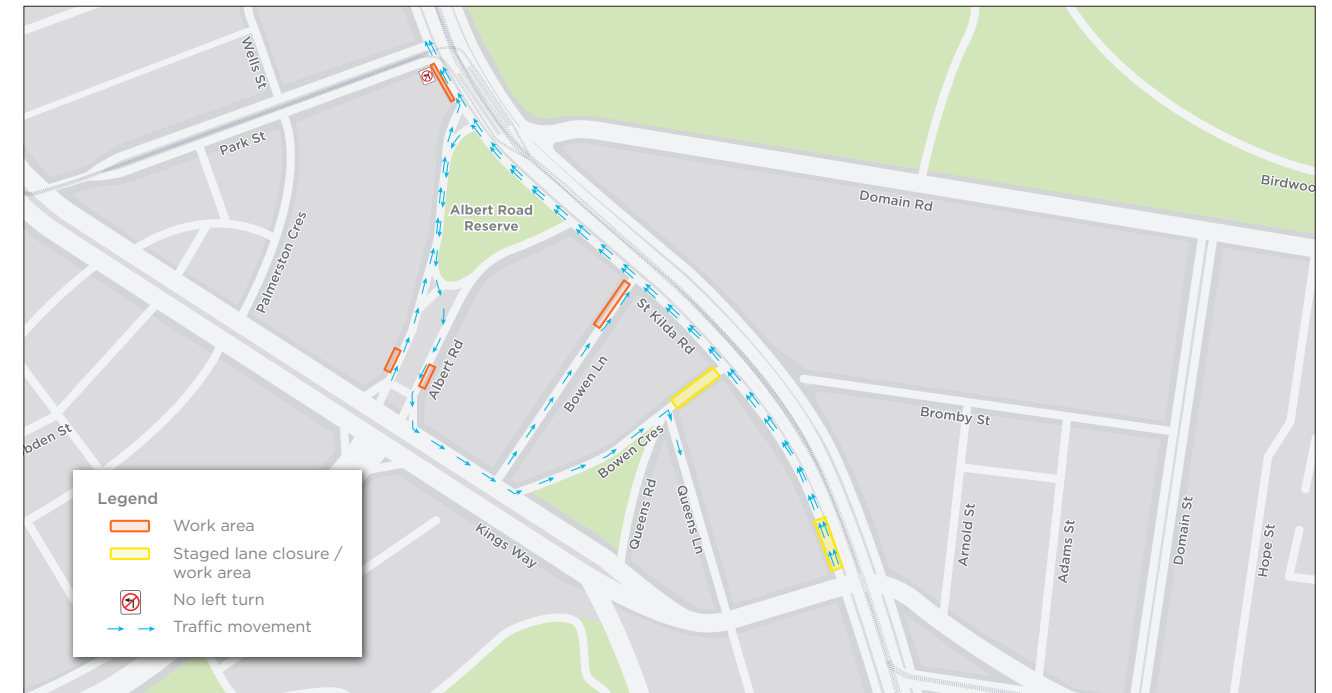

All maps are indicative only.

Eastbound and westbound lane closures on Bowen Crescent will be staged, with one 24-hour full road closure period for purging works.

Stage 4

- Cut-off and cap the existing low pressure gas mains on St Kilda Road adjacent to 416 St Kilda Road and on the corner of Park Street as well as Bowen Crescent, Bowen Lane and Albert Road
- Purging the gas from the mains, resulting in a controlled flame at the above locations
- Grouting the decommissioned gas mains.

Traffic impacts:

- Staged closures of the northbound lanes on St Kilda Road between Toorak Road and Bowen Crescent
- Staged closures of the eastbound and westbound lanes on Bowen Crescent for cut-off works, and a full road closure of Bowen Crescent between St Kilda Road and Queens Lane for a 24-hour period for purging activities

When

Day works

- 7am - 6pm, Monday to Friday
- 7am - 5pm, Saturdays
- Sundays as required (with advanced notice)

Night works for stage 3 will be required to install the gas regulator pit in Park Street South Melbourne. Further information will be provided when the timing of these works are confirmed.









What to be aware of

- There will be periods of medium to high level noise associated with open-cut trenching, saw-cutting and reinstating sections of road
- Impacts from noise will be managed in accordance with the Metro Tunnel's Environmental Performance Requirements
- There will be no impact to essential services associated with these works
- There will be traffic management in place around the work sites.

More information

To find out more about the Metro Tunnel Project and register for future email updates:

-  metrotunnel.vic.gov.au
-  1800 551 927 (24 hours a day, 7 days a week)
-  @metrotunnelvic
-  Melbourne Metro Rail Authority
-  facebook.com/metrotunnel
-  metrotunnelvic
-  Melbourne Metro Rail Authority, PO Box 4509, Melbourne, VIC 3001
-  Subscribe to eNews: metrotunnel.vic.gov.au/contact-us



Arabic	العربية	Russian	Русский
Cantonese	廣東話	Serbian	Српски
Greek	Ελληνικά	Sinhalese	සිංහල
Italian	Italiano	Spanish	Español
Korean	한국어	Turkish	Türkçe
Macedonian	Македонски	Vietnamese	Tiếng Việt
Mandarin	普通话		

Interpreter Service

(03) 9280 0700



Construction partners:



MMEW-JHG-DM-NTF-STK-0072



Authorised and published by the Victorian Government, 1 Treasury Place, Melbourne.