



## WORKS NOTIFICATION

### EXTENDED LINK ROAD CLOSURE, PREPARATION OF ST KILDA ROAD **FRIDAY 6 SEPTEMBER TO SUNDAY 13 OCTOBER**

Works in preparation for major construction of the Metro Tunnel Project and the new Anzac Station are continuing. The current phase of construction involves preparation for the realignment of St Kilda Road and tram occupation.

#### What we are doing

Before we can realign St Kilda Road during the tram occupation in October, we have to prepare the area to allow for the new road to be built

At the link road connecting Bowen Lane to Albert Road South, we will be completing kerb works, excavation, drainage instalment, pavement placement, asphaltting works and lighting works leading up to the commencement of the St Kilda Road realignment

Once these works are complete, Bowen Lane will reopen with a direct connection onto St Kilda Road.

#### When

Normal construction hours:

- 7am-6pm, Monday to Friday
- 7am-1pm, Saturday.

By completing these works now, the project team can reduce the amount of 24/7 works needed during the upcoming realignment of St Kilda Road.

#### What to be aware of

- For the duration of the works, the link road in front of The Domain, connecting Bowen Lane to Albert Road South will be closed to all vehicle traffic
- There will be intermittent pedestrian diversions along St Kilda Road between Albert Road and Bowen Lane during some works. These will be notified in advance with signage
- Residents of the Botanica who use the lower carpark will still be able to access their driveway from Bowen Lane.

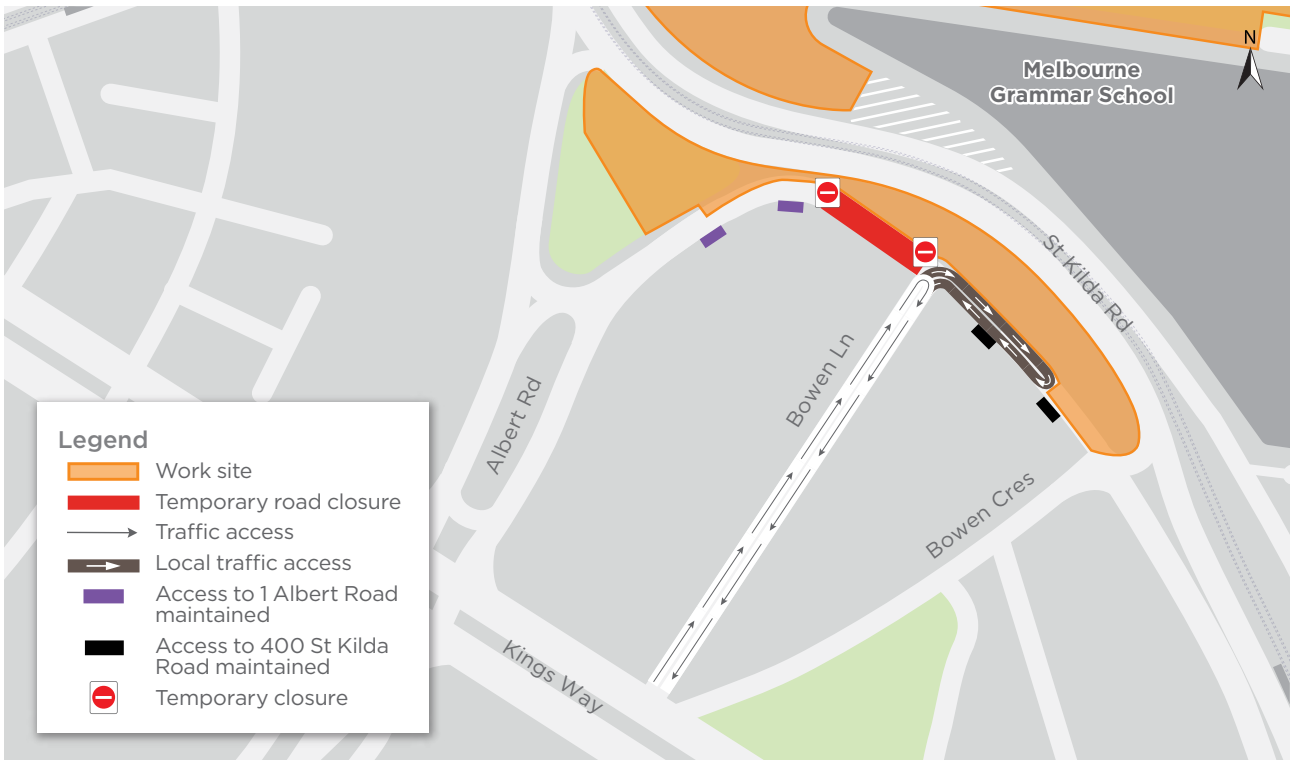

Indicative only

### More information

To find out more about the Metro Tunnel Project and register for future email updates:

- [metrotunnel.vic.gov.au](http://metrotunnel.vic.gov.au)
- 1800 105 105 (24 hours a day, 7 days a week)  
Press 2 and follow the prompts

- [facebook.com/metrotunnel](https://facebook.com/metrotunnel)
- Subscribe to eNews or construction notification emails: [metrotunnel.vic.gov.au/subscribe](mailto:metrotunnel.vic.gov.au/subscribe)

Interpreter Service (03) 9209 0147

It should be noted that this information is current at the time of printing, however due to unforeseen circumstances, changes may occur. Please visit [metrotunnel.vic.gov.au](http://metrotunnel.vic.gov.au) for the latest updates.