

Works notification

Scrubber installation Little La Trobe Street

October 2020

Works to deliver a scrubber (ventilation system) to the Little La Trobe Street site will take place on Friday 16 October under a road closure.

What we are doing

- Oversized delivery of a scrubber to Little La Trobe Street using a truck, tower crane and hand tools
- Lifting the scrubber from the road into the Little La Trobe Street site using cranes
- Working from Literature Lane with an elevated works platform
- Installing a scrubber, acoustic enclosure and site sheds on the western section of the Little La Trobe Street site.

What you should be aware of

- During these works, Little La Trobe Street and Literature Lane will only be accessible to motorists via Elizabeth Street (refer to map)
- During these works, a section of Literature lane will be temporarily closed to pedestrians and motorists (refer to map)
- Local access for residents and businesses will be maintained at all times
- Traffic management will be in place, to safely guide pedestrians, cyclists, and motorists around the work area

- These works are expected to generate medium levels of noise
- The ventilation system, acoustic enclosure and elevated site sheds will be in place for about two years.

When

Oversized delivery of scrubber to Little La Trobe Street

1am to 5am, Friday 16 October 2020

Little La Trobe Street and Literature Lane motorist access from Elizabeth Street only

1am to 2pm, Friday 16 October 2020

7am to 2pm, Monday 19 October 2020

7am to 6pm, Tuesday 20 October 2020

Scrubber, acoustic enclosure and site shed installation works

7am to 6pm, Monday to Saturdays, ongoing until November 2020

6pm to 10pm, Monday to Fridays (as required), ongoing until November 2020.

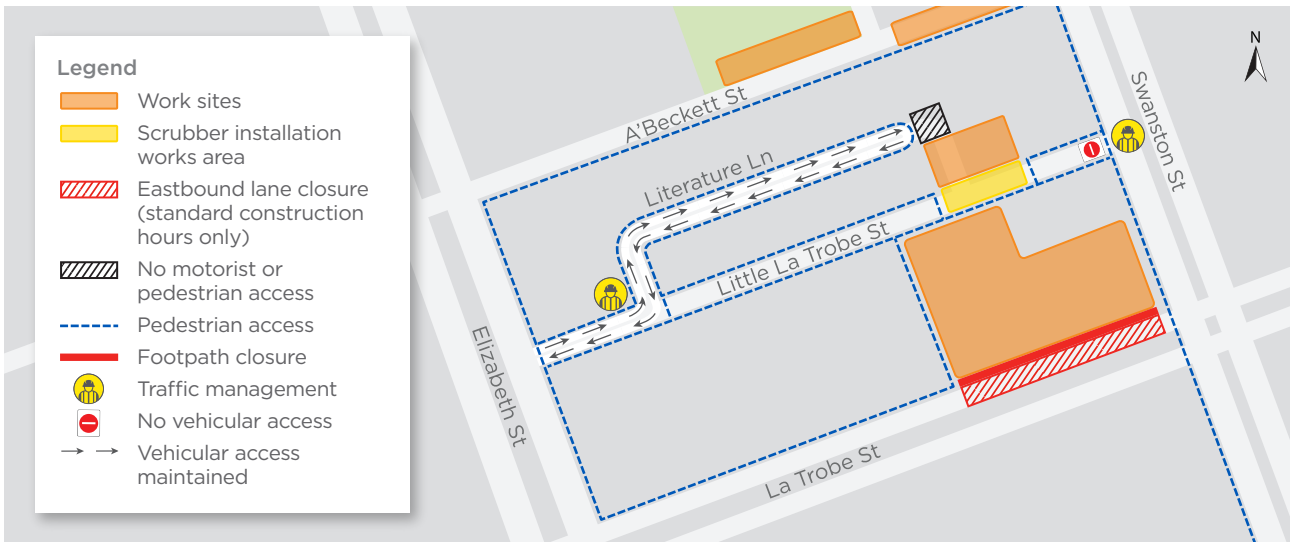

Little La Trobe Street motorist access during scrubber installation works

Health and safety

Metro Tunnel Project works are progressing safely under the current Second Step restrictions in metropolitan Melbourne.

You may notice an increase of workers on Victoria's Big Build projects as restrictions on construction sites start to ease. Large-scale public infrastructure projects are critical and strict COVIDsafe Plans are in place on all project sites across Victoria.

The health and safety of our workforce and community remains our top priority. Workers on all of Victoria's Big Build sites are required to wear face masks unless they meet any of the criteria for exception – such as a medical condition for Occupational Health and Safety guidelines.

Physical distancing measures are in place as well as increased hygiene practices.

For more information and advice about the coronavirus (COVID-19), please visit <http://coronavirus.vic.gov.au>.

More information

To find out more about the Metro Tunnel Project:

 metrotunnel.vic.gov.au

 1800 105 105 (24 hours a day, 7 days a week)

Rail Projects Victoria
PO Box 4509, Melbourne, VIC 3001

 Interpreter Service (03) 9209 0147

It should be noted that this information is current at the time of printing, however due to unforeseen circumstances, changes may occur. Please visit railprojects.vic.gov.au for the latest updates.