



## WORKS NOTIFICATION

# LITTLE LA TROBE STREET TOWER CRANE INSTALLATION AUGUST 2020

Major works on the Metro Tunnel are underway to support construction of the new State Library Station at the northern end of Swanston Street in the CBD.

Little La Trobe Street will be temporarily closed to motorists during works to install a tower crane within the Little La Trobe Street site. The tower crane will facilitate the construction of the new State Library Station.

### What we are doing

- Mobilising a mobile crane using heavy vehicles and hand tools
- Delivering and installing oversized tower crane segments
- Assembling a tower crane within the Little La Trobe Street site using a mobile crane, trucks, hand tools, elevated works platforms, power tools, rattle guns, light towers, and a generator
- Temporarily closing Little La Trobe Street to facilitate these works.

### What to be aware of

- The tower crane will be located within the Little La Trobe Street site and will be in place for about three years
- A section of Little La Trobe Street will be closed to motorists from 4am to 10pm on Friday 14 August 2020
- A section of Little La Trobe Street will also be closed to motorists from 7am on Thursday 27 August to 10pm on Saturday 29 August 2020

- If works are unable to be completed on these dates they will be undertaken on the next available shift. Please refer to the 'when' section of this notification for contingency dates
- During the closures, Little La Trobe Street and Literature Lane will only be accessible to motorists via Elizabeth Street (refer to map)
- For safety reasons there will be intermittent holding of pedestrians during lifts over Little La Trobe Street
- Please allow additional travel time
- Local access for residents and businesses will be maintained at all times (refer to map overleaf)
- Traffic management will be in place during works to safely guide pedestrians, cyclists, and motorists around the work area
- These works are expected to generate intermittent periods of high noise during the assembly of the tower crane.

### When

#### Little La Trobe Street closures

- 4am to 10pm, Friday 14 August 2020
- 7am Thursday 27 August to 10pm Saturday 29 August 2020
- Sunday 30 August 2020 (if required)

**Oversized deliveries and tower crane assembly works**

- 4am to 10pm, Friday 14 August 2020
- 7am Thursday 27 August to 10pm Saturday 29 August 2020
- Sunday 30 August 2020 (if required)

**Please also be advised**

The eastbound lane on La Trobe Street is currently closed between Elizabeth and Swanston streets from 7am to 6pm, Monday to Fridays, and from 7am to 1pm on Saturdays. This closure will now be in place until Sunday 13 September 2020.

For your safety, please follow the detour signs in place.

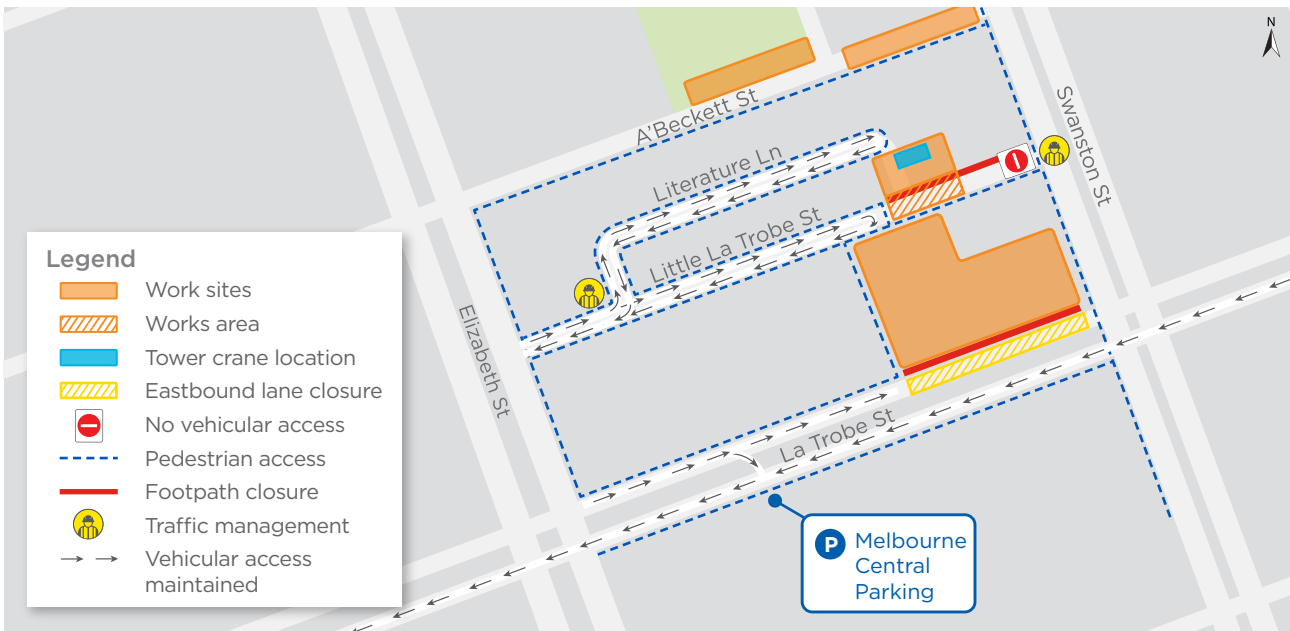

Indicative only

**More information**

To find out more about the Metro Tunnel Project and register for future email updates:

- [metrotunnel.vic.gov.au](http://metrotunnel.vic.gov.au)
- 1800 105 105 (24 hours a day, 7 days a week)  
Press 2 and follow the prompts

- [facebook.com/metrotunnel](https://facebook.com/metrotunnel)
- Subscribe to eNews or construction notification emails: [metrotunnel.vic.gov.au/subscribe](mailto:metrotunnel.vic.gov.au/subscribe)

Interpreter Service (03) 9209 0147

It should be noted that this information is current at the time of printing, however due to unforeseen circumstances, changes may occur. Please visit [metrotunnel.vic.gov.au](http://metrotunnel.vic.gov.au) for the latest updates.