



WORKS NOTIFICATION

LA TROBE STREET SITE CONCRETE POUR JUNE 2020

Major works on the Metro Tunnel are underway to support construction of the new State Library Station at the northern end of Swanston Street in the CBD.

To safely facilitate large continuous concrete pours to the La Trobe Street site, a section of Little La Trobe Street will be closed to motorists on Wednesday 24 and Tuesday 30 June.

What we are doing

- The concrete pours are required to construct the future State Library Stations permanent ground floor slab
- A concrete pump will be temporarily installed on Little La Trobe Street, adjacent to the La Trobe Street site during these works
- To accommodate the temporary concrete pump a partial road closure is required (refer to map)
- Concrete pours and concrete finishing works will require the use of concrete trucks, a concrete pump, concrete vibrators, a non-destructive digging truck, hand tools, and concrete finishing equipment
- Concrete pours must be continuous to ensure structural integrity and therefore will take place from 7am up to 10pm on Wednesday 24 and Tuesday 30 June.

What to be aware of

- Access to Little La Trobe Street and Literature Lane during the closures will be via Elizabeth Street (refer to map)
- Some works are required to take place at night and will generate medium to high levels of noise
- Access to businesses and residential buildings will be maintained at all times
- Traffic management will be in place during works to safely guide pedestrians, cyclists, and motorists around the work area.

When

Little La Trobe Street closures

7am-6pm, Wednesday 24 June 2020

7am-6pm, Tuesday 30 June 2020

Concrete pour and concrete finishing works

7am-10pm, Wednesday 24 June 2020

7am-10pm, Tuesday 30 June 2020

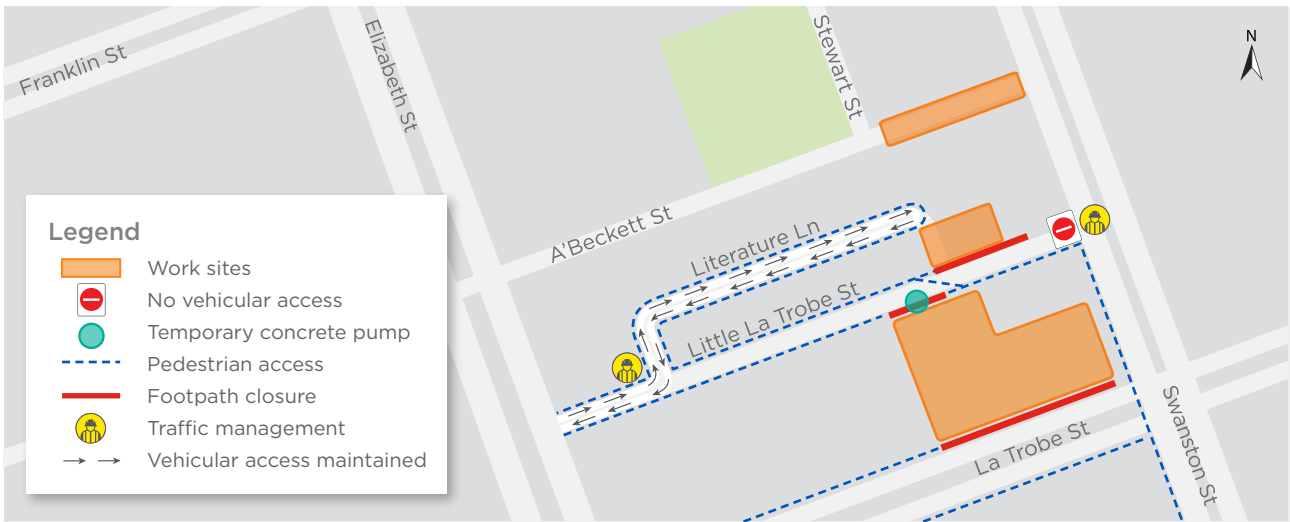

Indicative only

More information

To find out more about the Metro Tunnel Project and register for future email updates:

- metrotunnel.vic.gov.au
- 1800 105 105 (24 hours a day, 7 days a week)
Press 2 and follow the prompts

- facebook.com/metrotunnel
- Subscribe to eNews or construction notification emails: metrotunnel.vic.gov.au/subscribe

Interpreter Service (03) 9209 0147

It should be noted that this information is current at the time of printing, however due to unforeseen circumstances, changes may occur. Please visit metrotunnel.vic.gov.au for the latest updates.